

Fuel Filter Replacement

The fuel filter should [be replaced whenever the fuel pressure drops below the specified value](#) , after making sure that the fuel pump and the fuel pressure regulator are OK.

1. [Remove the fuel pump.](#)
2. Remove the fuel filter set (A).

Except ECONO model:

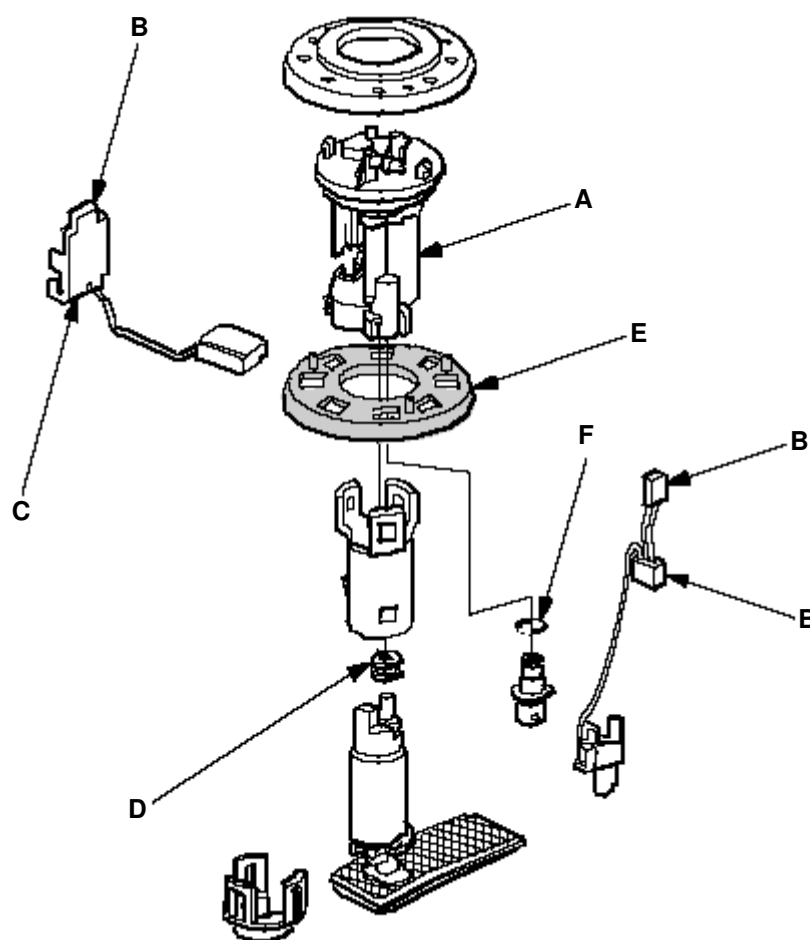

ECONO model:

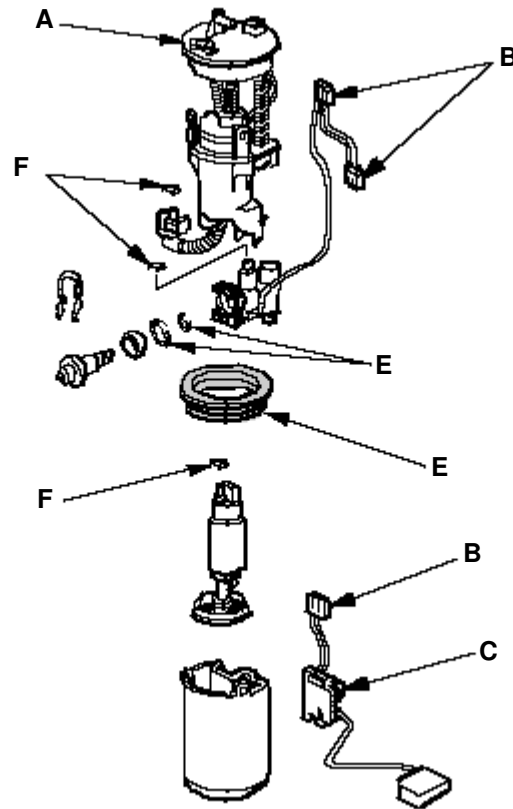

3. Check these items before installing the fuel tank unit:

- When connecting the wire harness, make sure the connection is secure and the connectors (B) is firmly locked into place.
- When installing the fuel gauge sending unit (C), make sure the connection is secure and the connector is firmly locked into place. Be careful not to bend or twist it excessively.
- When installing the grommet (D), coat the grommet with clean engine oil.

4. Install the parts in the reverse order of removal with a new base gasket (E) and new o-rings (F). When installing the fuel tank unit, align the marks on the unit and the fuel tank.